

what you said

The masterplan should help to provide affordable housing.

Ground floor flats are important for people who are less mobile - there are long waiting lists for these.

The new buildings should be designed to blend in with the existing blocks. Light coloured brick is preferable.

I like the emerging designs - I would like to live in one of the new buildings.

BUILDING NEW HOMES

homes in the masterplan

The masterplan include 136 new homes as well as 75 new 'extra care' homes for elderly residents, in place of Cheshir House which is no longer fit for purpose. The homes are:

- 49 one bed homes, 79 two bed homes, 8 three bed family homes, 73 one bed extra care homes, 2 two bed extra care homes
- 45% affordable homes, 6% shared ownership and 49% market sale homes

- Affordable rent or shared ownership homes will be allocated to people in housing need in the local area, prioritised by Barnet Council's allocations policy
- All the affordable rent homes, including the extra care homes, will be managed by Barnet Homes
- The sale of homes on the open market will fund the affordable housing and estate improvements
- 22 of the homes will be wheelchair accessible

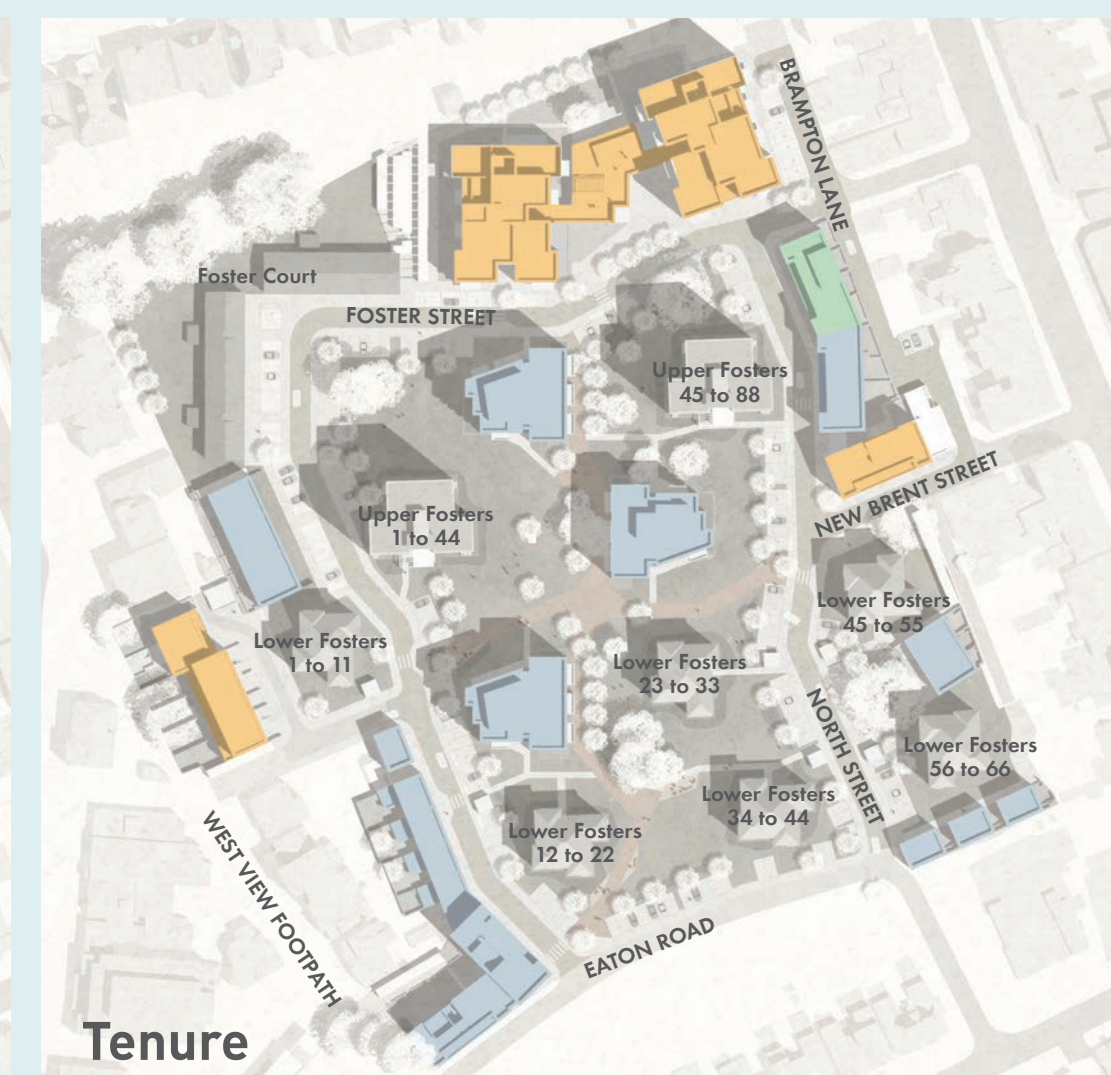
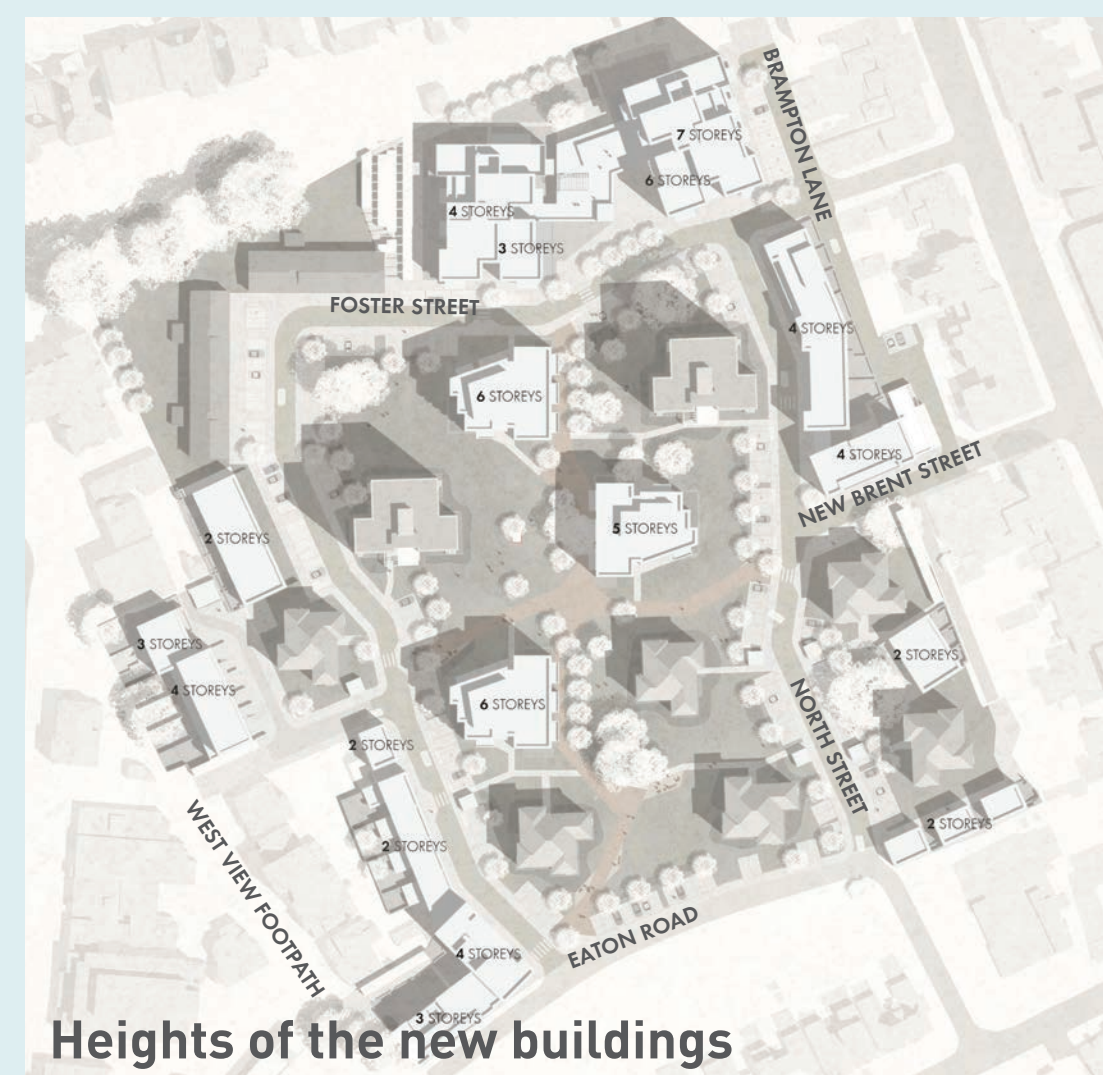

- affordable
- shared ownership
- private

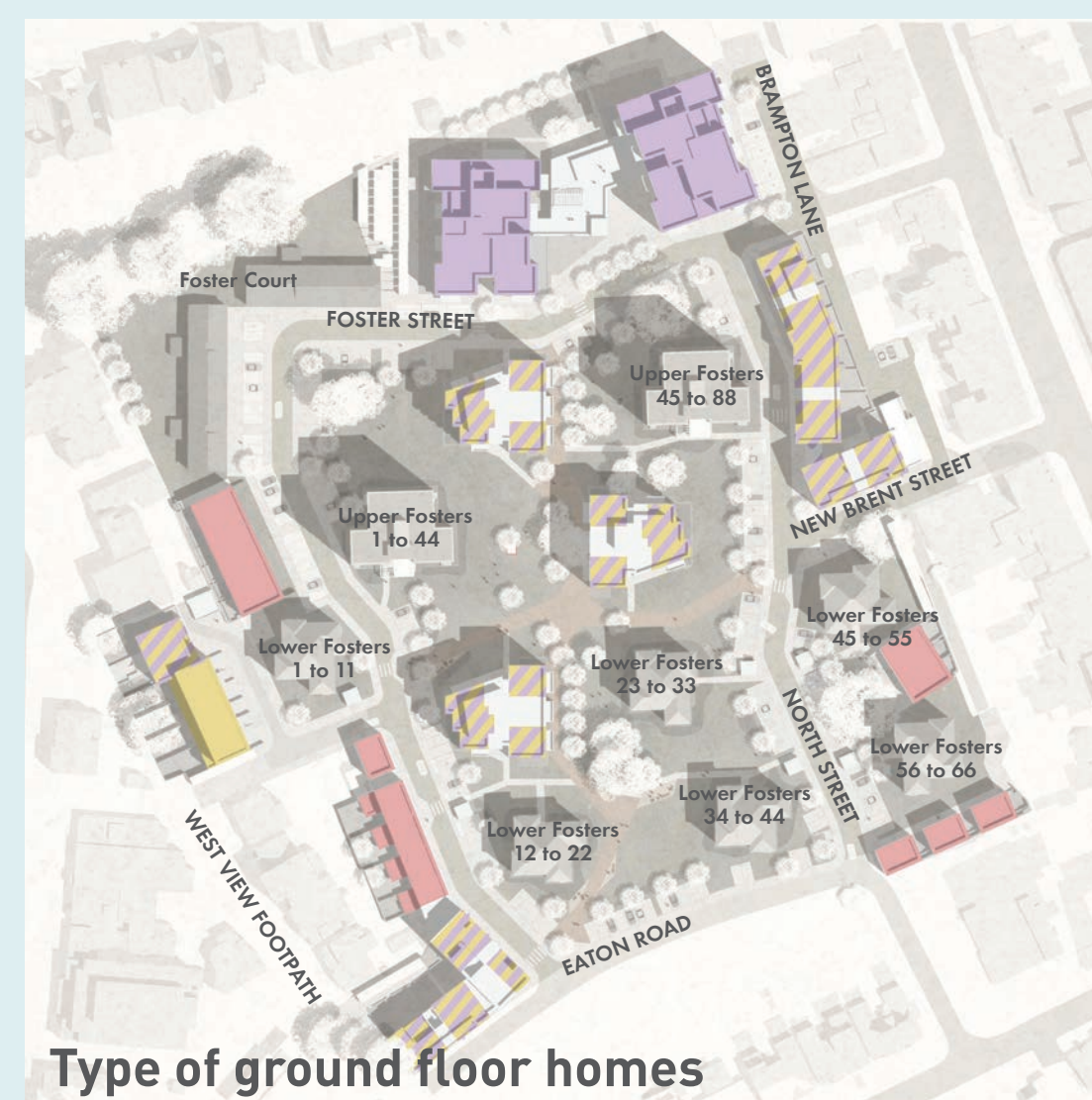

- apartment
- maisonette
- house

WHAT IS AFFORDABLE HOUSING?

Affordable housing is social rented, affordable rented and intermediate housing which will be allocated to people in housing need in the local area and will be managed by Barnet Homes.



the extra care building

The extra care building will provide state of the art accommodation for elderly and those with specific care needs, providing residents with the support they need to continue living independently at affordable rents.

The one and two bedroom extra care apartments will be fully accessible and bright, each with their own balcony.

- Shared facilities will provide space for activities, exercise and socialising, including:
- a resident and visitor cafe on the ground floor;
 - a first-floor terrace with a pergola;
 - space which can be booked for parties or events;
 - and places to sit beside a window and take in the views.

The garden behind the extra care building will become a 'secret garden', providing a serene place for residents to relax and enjoy nature.



buildings in the park

Three new buildings will be positioned between the existing blocks in the centre of the estate. These will be aligned with the existing Fosters blocks and built using light-coloured brickwork.

The buildings will have bike storage, bins and post-boxes incorporated within them.

These blocks typically have five flats per floor. The ground floor homes are set over two floors, helping to provide family homes and wheelchair-accessible homes.

